



# Explosion Proof LED Exit Light SIP-EXIT



**Emergency Exits In Hazardous Locations**

**SIINPRO**  
**LIGHTING**  
INDUSTRIAL SAFE LIGHTS

5756 GRACEPI, LOSANGELES CA 90022, USA

[WWW.SIINPROLIGHTING.COM](http://WWW.SIINPROLIGHTING.COM)

# Applications

## Oil and Gas industry

- All petroleum production and refining
- Petroleum loading and transportation
- Petroleum storage and retail
- LNG industry

- All mining operations and service

## Chemical industry

- All types of paint facilities
- Chemical production and storage

## Ocean, marine and aerospace field

- Ocean platform operation facilities and structure
- Aerospace clean room and production
- Ocean vessel operations

## Metal treatment

- Steel and aluminum factories
- Pumping stations in any environment
- Metal smelting, foundry and fabrication

## Food and alcohol industry

- Flour and fine particle production and storage
- Food and distilling production
- Alcohol industry

Other high humidity, high dust, high temperature, vapor locations



**SIINPRO**  
LIGHTING®

INDUSTRIAL SAFE LIGHTS

5756 GRACEPI, LOSANGELES CA 90022, USA

[WWW.SIINPROLIGHTING.COM](http://WWW.SIINPROLIGHTING.COM)



## Features

- Working Temperature: -20°C ~ +60°C.
- Light-weight and compact.
- High vibration and high impact resistance.
- Integrated junction box for driver with emergency back up.
- Content displayed on the indicator is replaceable.
- Low working wattage for energy saving.
- High leakproofness up to Ip66.
- Up to 5 years limited warranty option.
- Emergency time can be 180 minutes.
- Long lifespan up to 50,000 hours.
- Stainless steel exposed fasteners with high corrosion resistance.

## Materials

- Housing: Aluminum
- Lens: Tempered Glass
- Bolts: Stainless Steel
- Mounting Sling: Aluminum

## Specification



Model	Wattage	CCT	Voltage Options	Warranty	Emergency Time(Optional)
SIPEXI-3W VYZDA	3W	2200-7000K	AC: 100-277V AC/DC: 12-48V	5 years	3 hours

"V"= Product code "Y"= Dimmable or Non-dimmable, non dimmable for model V "Z"=CCT, from 2200K-7000K.  
 "D"= Beam angle, no angle for model V "A"= Glass type, no glass type for model V.

## Explosion Protection

Marking Atex

IIC G Ex ib op is IIC T6 Gb

IIC D Ex op is tb IIIC T80°C Db Ip66

Marking IECEX

Ex ib op is IIC T6 Gb

Ex op is tb IIIC T80°C Db IP66

Marking UI844 (North American)

Class I, Division 2, Groups A, B, C, D

Class II, Division 1, Groups E, F, G

Class II, Division 2, Groups F, G

Class III

Marking Marine

UL 924

Other Rating

IP 66



INDUSTRIAL SAFE LIGHTS

5756 GRACEPI, LOSANGELES CA 90022, USA

WWW.SIINPROLIGHTING.COM

# Dimension Unit: mm or inch

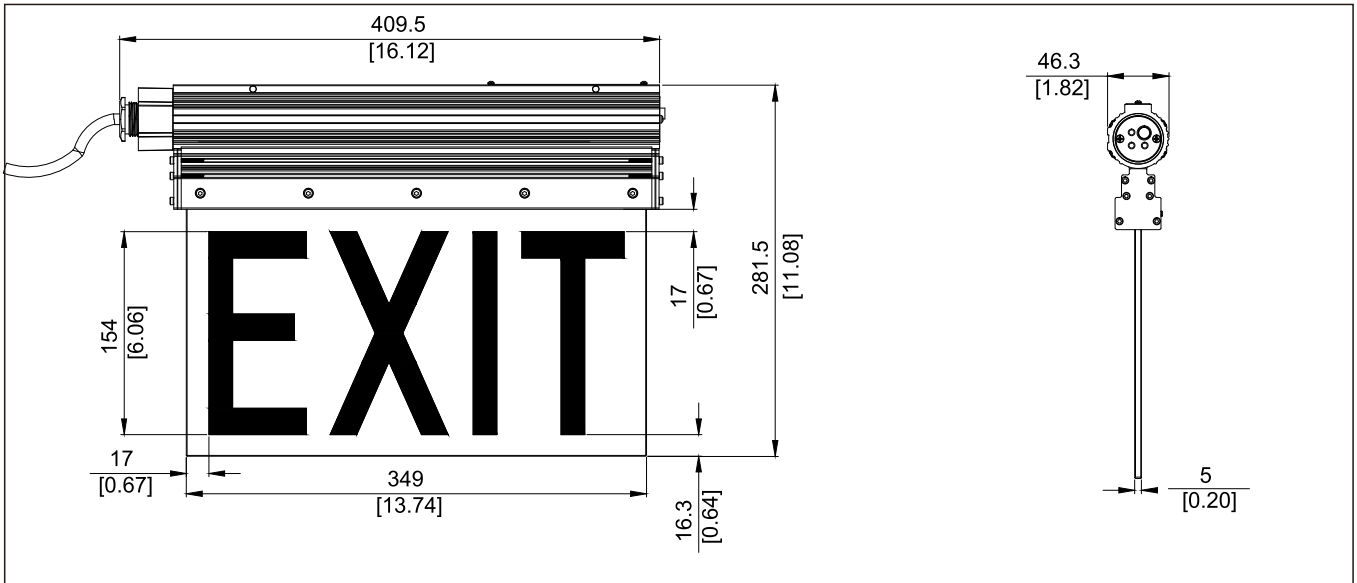

## Packing Information

Model	Quantity/Ctn	Length(cm)	Width (cm)	Height(cm)	Net weight(kg)	Gross weight (kg)
SIP-EXIT	2	47	47	26	3.3	7

## Mounting

### Pendant Mounting

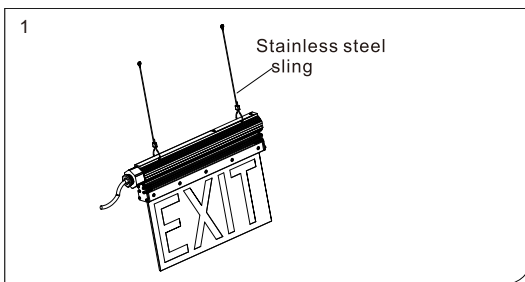

Take the fixture and accessories out from carton box, and tie the stainless steel sling on the fixture as Fig. 1.

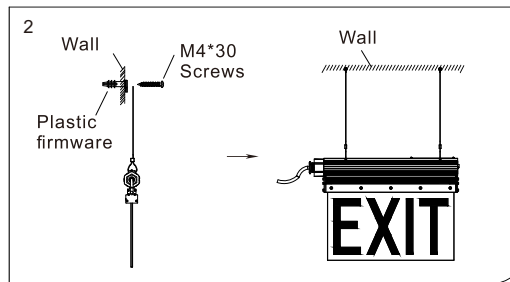

Drill 2 holes on the wall as Fig.2, fix 2 plastic firmware on the hole, then fix screw(M40\*30) with the fixture into the holes.

## Accessories



Fix plate

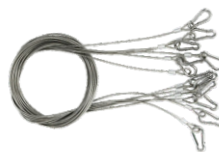

Sling rope

